

slimline 32/4

PRODUCT IMAGE



TECHNICAL DATA

product description:	Decorative acoustic panel for walls and ceilings for mounting on substructure.
dimension:	2.784 x 192 mm
slotting:	32/4
core-board:	16 mm MDF B2 E1 drilled
surface:	vener CPL melamine
fire classification:	C-s2, d0 acc. DIN EN 13501-1 (in composite) limited contribution to fire (others on request)
edges:	longitudinal : tongue and groove system transverse : industrial saw cut
mounting:	vertical horizontal wall ceiling
accessories:	mounting-clip (optional)

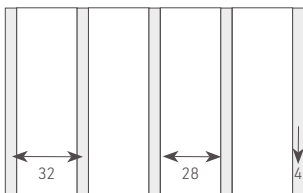

slotting:
4 mm slot + 28 mm slat

PROVISIONAL NOTE:

This data sheet has been prepared to the best of our knowledge and belief. No liability can be assumed for printing and standard errors as well as errors. Due to (product) further development, there may be changes to the available data. The content of this data sheet should not be used as a legally binding basis.

SOUND ABSORPTION VALUES

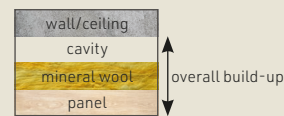

overall build-up	216 mm
cavity (open)	150 mm
insulation	50 mm
panel thickness	16 mm
frequency [Hz]	α_s
100	0,42
125	0,53
160	0,65
200	0,75
250	0,86
315	0,89
400	0,80
500	0,81
630	0,79
800	0,78
1000	0,82
1250	0,75
1600	0,69
2000	0,64
2500	0,57
3150	0,58
4000	0,63
5000	0,64
α_w	0,70
NRC	0,76
SAA	0,80
absorber class	C

